



深圳博时特科技有限公司
Bozz Technology (ShenZhen)Co.,Ltd

Smart Check Out Series



IP66

Dustproof/ Waterproof
Resistant to oil, steam, and insects



Palm / Card / QR Integrated Payment Device/ RFID Self /Check Out Kiosk

Group meal smart cashier terminal Model:F630/F638/F639

Product features

- * Hanging cash register, 5 "+ 8" display, support dual screen synchronous display;
- * Support face scanning payment, code scanning payment, credit card payment three payment methods;
- * The body comes with a replaceable mechanical keyboard, flexible installation, easy to use;
- * Main aviation grade aluminum alloy material, strong and durable;
- * Waterproof, lampblack prevention design, protection level can reach IP66.

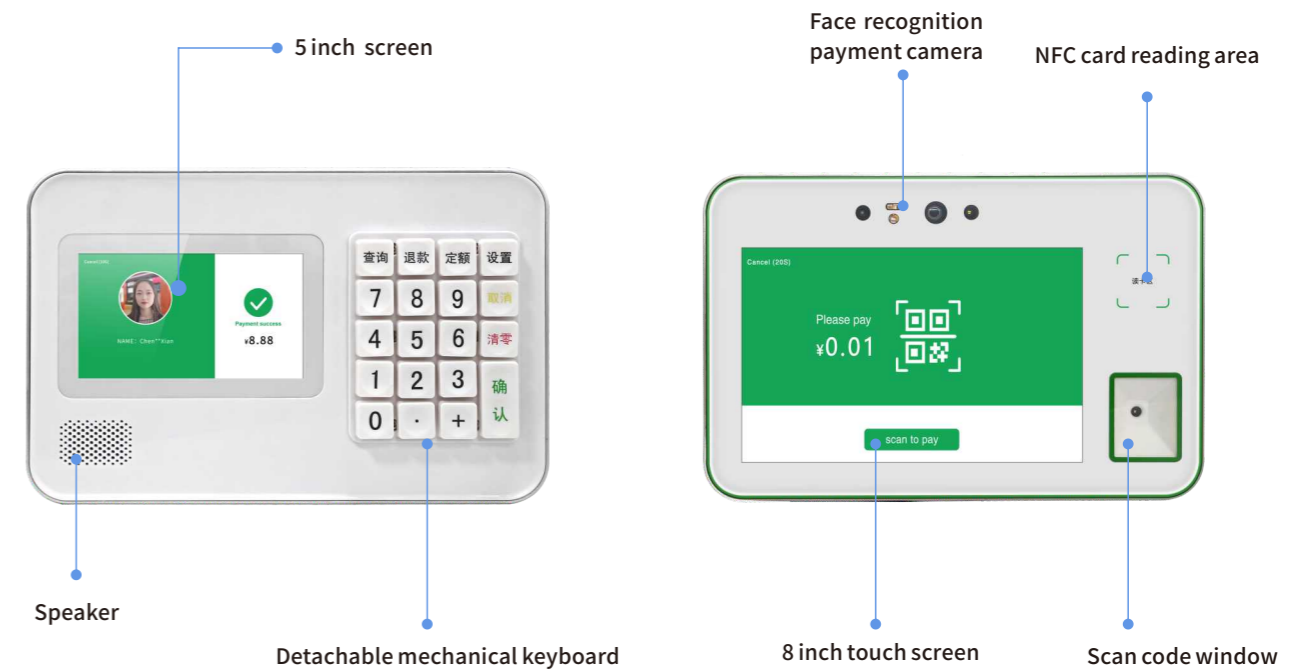
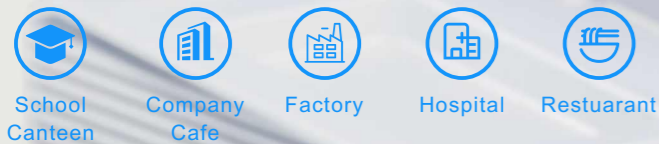

Product Parameters

Items	Product parameters		
Model	F639	F638	F630
CPU	Rk 3399	Rk 3288	Rk PX30
Operation system	Android 7.1	Android 7.1	Android 8.1
Momery	4G DDR+16G EMMC	2G DDR+8G EMMC	1G DDR+8G EMMC
Display screen	5"(854*480)+8"(1280*800)		
touch screen	G+G capacitive multi-touch		
Camera	200W binocular width dynamic / 3D structure light		None
Scan code window	High-speed recognition, supports paper and screen 1D / 2D scanning (Optional)		
card reader	Support IC card swiping (optional)		
Standard network	RJ45、WIFI、Bluetooth		
Speaker	3W*2		
keyboard	Interchangeable mechanical keyboard		
Power adapter	12V/2A		
Battery	2000 mAh lithium battery (optional)		
External I/O	USB Type-A *2		
	RJ45 LAN*1		
	Micro-USB debugging port *1		
	DC power supply port *1		
	Micro TF Card slot, max. 64G (optional)		
	SIM card slot (optional with 4G full netcom)		

Group meal smart cashier terminal Model:F630D/F638D/F639D

Product features

- * Desktop cash register, 5 "+ 8" display, support dual screen synchronous display;
- * support face payment, code scanning payment and card payment;
- * body with replaceable mechanical keyboard, flexible installation, easy to use;
- * main aviation grade aluminum alloy, strong and durable;
- * Designed to be waterproof and oil-proof, the protection level can reach Ip66.

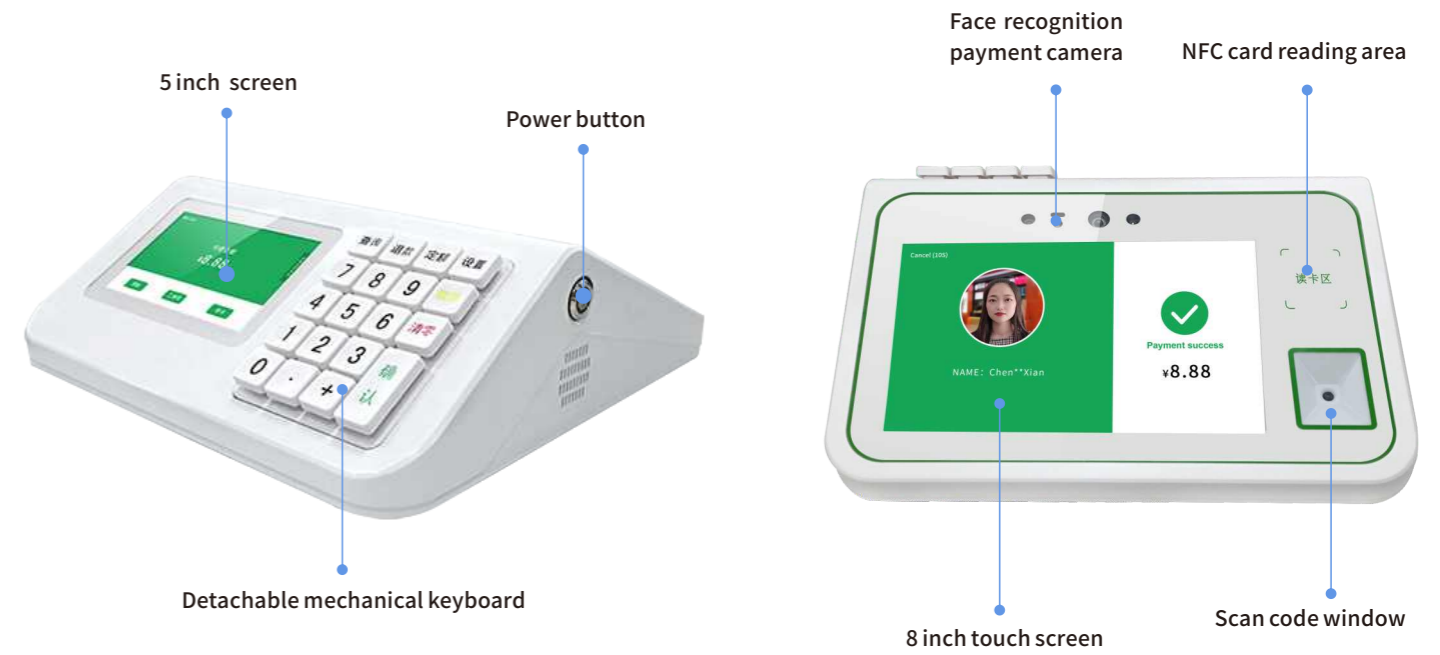

Product Parameters

Items	Product parameters		
Model	F639D	F638D	F630D
CPU	Rk 3399	Rk 3288	Rk PX30
Operation system	Android 7.1	Android 7.1	Android 8.1
Momery	4G DDR+16G EMMC	2G DDR+8G EMMC	1G DDR+8G EMMC
Display screen	5"(854*480)+8"(1280*800)		
touch screen	G+G capacitive multi-touch		
Camera	200W binocular width dynamic / 3D structure light		None
Scan code window	High-speed recognition, supports paper and screen 1D / 2D scanning (Optional)		
card reader	Support IC card swiping (optional)		
Standard network	Rj45 , WIFI, Bluetooth		
Speaker	3W*2		
keyboard	Interchangeable mechanical keyboard		
Power adapter	12V/2A		
Battery	2000 mAh lithium battery (optional)		
External I/O	USB Type-A *2		
	RJ45 LAN*1		
	Micro-USB debugging port *1		
	DC power supply port *1		
	Micr o TF Card slot, max. 64G (optional)		
	SIM card slot (optional with 4G full netcom)		

Smart group meal facial recognition cashier terminal Model:P15G/P15G-M

Product features

- ★ Canteen and group meal stalls for the use of both cashier and users;
- ★ Interactive dual screen design, can be set with dual screen display, dual screen display;
- ★ Optional 13.3"+13.3"/12.1"+12.1" IPS, LCD display screen;
- ★ Can be matched with a 3D structured light camera to support face payment;
- ★ 180° rotatable holder with a maximum tensile distance of 60CM.



Product Parameters

Items	Product parameters	
Model	P15G	P15G-M
Display screen	13.3"+13.3"(1920*1080)	12.1"+12.1"(1600*900)
CPU	Rk3399 A72*2+ A53*4 CPU frequency 1.8GHz & Mail T860	
Operation system	Android 7.1	
Momery	4G DDR+16G EMMC	
touch screen	G+G capacitive multi-touch	
Camera	200W binocular width dynamic / 3D structure light	
Standard network	RJ45 , WIFI, Bluetooth	
4G network	4G full netcom (optional)	
Power adapter	12V/3A	
Speaker	3W*1	
External I/O	USB Type-A *2	
	Rj45 LAN*1	
	Type-C Debug port *1	
	DC Power port*1	
	Dedicated DP interface*1	
	Support Micro TF card slot, maximum 64G	
	SIM card slot (optional 4G full network)	



School Canteen



Company Cafe



Factory



Hospital



Restuarant

Intelligent weighing and settlement terminal Model:M19

Product features

- ★ Dual screen (4.3 + 7-inch) display screen, integrated structure;
- ★ NFC automatic induction plate, bowl;
- ★ plate RS485 Network networking and communication.

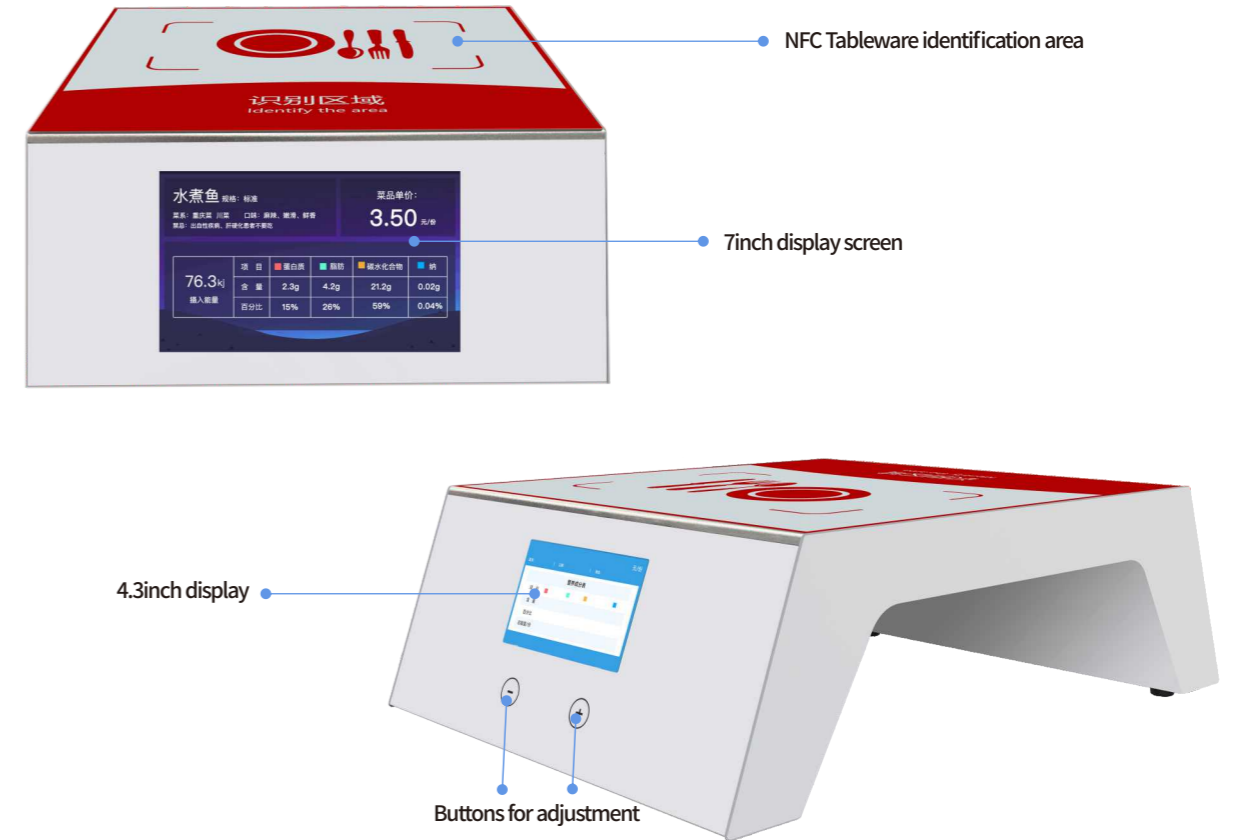
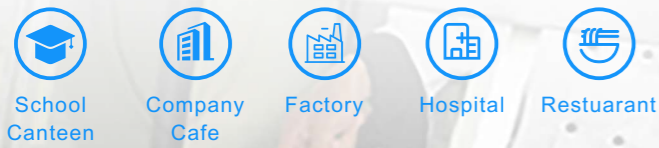

Product Parameters

Items	Product parameters
CPU	Am7331 (2pcs)
Operation system	MCU Kernel mini-system
Momery	4M +6M
Display screen	4.3inch display screen (480*272 resolution) 7inch display screen (optional) (800*480 resolution)
NFC module	Support 15693 protocol, IC card, CPU card
Recognition distance	0~5CM
Buzzer	Announcement sound prompts
Power adapter	DC 12V/3A
Protection level	IP66
External I/O	DC input 12V*1
	DCoutput12V*1
	485 input*1
	485 output *1
	Electronic scale interface*1
	USB 2.0

Scan code, weigh and settle all-in-one machine Model:PT310

Product features

- ★ Scan the code to bind the plate, weighing and payment in one step, reduce the queuing time of group meals;
- ★ k 3288 The quad-core processor is equipped with Android operating system and supports the installation of App based on Android system;
- ★ Built-in code scanning window, by scanning the two-dimensional code plate can quickly take food settlement;
- ★ It can provide appearance, configuration, and function customization, has strong scalability, and supports OEM/ODM.



Product Parameters

Items	Product parameters
CPU	Rk3288 A17*4 main frequency 1.8GHz & Mali T764
Operation system	Android 7.1
Momery	2G DDR+8G EMMC
Power adapter	12V/2A
Display screen	10.1" full viewing angle, resolution: 1280*800
touch screen	G+G Multi-point capacitive touch
Scan code window	High-speed recognition, supports 1D/QR scanning of paper and screen
Electronic scale	Accurate scale platform identification, gram level starting
Speaker	3W*1
Standard network	RJ45, WIFI, Bluetooth
4G network	4G full network access (optional configuration)
Mechanical material	Stainless steel body
machine size	490*880*358mm
External I/O	USB Type A *2
	RJ45 LAN*1
	DC Power port*1

Scan code, weigh and settle all-in-one machine Model:PT311

Product features

- ★ Scan the QR code to bind the plate, weigh, settle and pay in one step, saving queuing time;
- ★ The Rk3288 quad-core processor is equipped with the Android operating system and supports the installation of apps based on the Android system;
- ★ Hard-decoded code scanning window allows you to quickly pick up and settle meals by scanning the QR code on the plate; RFID module for quick identification;
- ★ It can provide appearance, configuration, and function customization, has strong scalability, and supports OEM/ODM.



Product Parameters

Items	Product parameters
CPU	Rk3288 A17*4 main frequency 1.8GHz & Mali T764
Operation system	Android 7.1 Bozz OS
Momery	2G DDR+32G EMMC
Power adapter	12V/2A
Display screen	8" full viewing angle, resolution: 800*1280
touch screen	G+G Multi-point capacitive touch
Scan code window	High-speed recognition, supports 1D/QR scanning of paper and screen
Electronic scale	Accurate scale platform identification, gram level starting
Speaker	2W*1
Standard network	RJ45, WIFI, Bluetooth
4G network	4G full network access (optional configuration)
External I/O	USB Type A*2
	RJ45 LAN*1
	DC Power port*1

Visual Recognition Smart Dining Table Model:P29

Product features

- ★ Rk3399 high-performance six-core processor;
- ★ Based on the deeply optimized and improved operating system of Android, it supports the installation of apps based on Android system;
- ★ 15.6" high-definition full-view display, supporting G+G multi-point capacitive touch;
- ★ 2 million pixel dish recognition camera, automatic recognition, and quick calculation of the entire menu price;
- ★ Optional facial recognition payment module, QR code scanning module, and NFC card swiping module.
- ★ It can provide appearance, configuration, and function customization, has strong scalability, and supports OEM/ODM.

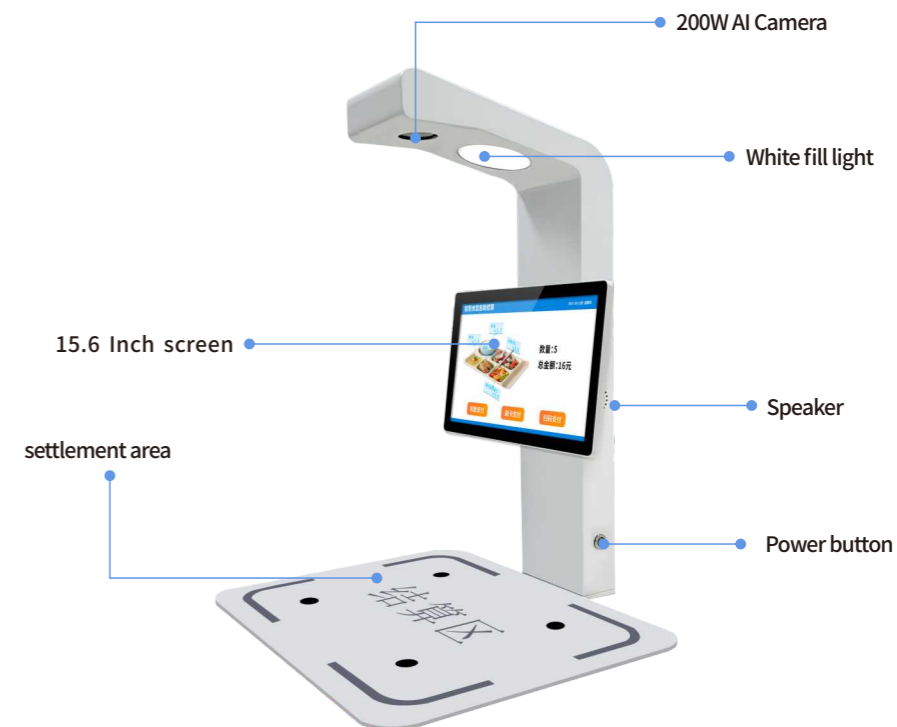

产品参数 PRODUCT PARAMETERS

Items	Product parameters
CPU	Rk3399 A72*2+ A53*4 CPU frequency 1.8GHz & Mail T860
Operation system	Android 7.1 BOZZ OS
Momery	4G DDR+16G EMMC
Power adapter	12V/3A
Display screen	15.6" IPS, Resolutions: 1920*1080+1920*1080
touch screen	G+G Multi-point capacitive touch
Dishes recognition camera	200W HD camera
Scan code window	High-speed recognition, supports 1D/2D scanning of paper and screen
NFC	Support IC card swiping
Face recognition payment camera	200W dual-purpose wide dynamic camera/3D structured light camera optional
Speaker	3W*1
Standard network	RJ45 , WIFI, Bluetooth
4G network	4G full network access (optional configuration)
External I/O	USBA *2
	RJ45 LAN*1
	Micro-USB Debug port *1
	DC Power port*1
	Support Micro TF card slot

RFID identifies smart device Model:P915

Product features

- ★ The smart hall is fully self-service settlement, which is convenient and fast to use and saves queuing time;
- ★ Rk3399 high-performance six-core processor;
- ★ Supports RFID dish recognition, quickly identifies dinner plates and completes calculations;
- ★ 15.6H+15.6H high-definition full-view display, supporting G+G multi-point capacitive touch;
- ★ Supports 1D/QR scan code payment, with wide viewing angle and fast recognition;
- ★ built-in NFC card reading module, supports card consumption;
- ★ Optional face recognition payment camera can be used for multi-angle recognition;
- ★ The cabinet body is made of high-strength sheet metal stamping and spray-painting technology, and the structure is solid and reliable, beautiful and easy to clean;
- ★ It can provide appearance, configuration, and function customization, has strong scalability, and supports OEM/ODM.



School
Canteen



Company
Cafe



Factory



Hospital



Restaurant

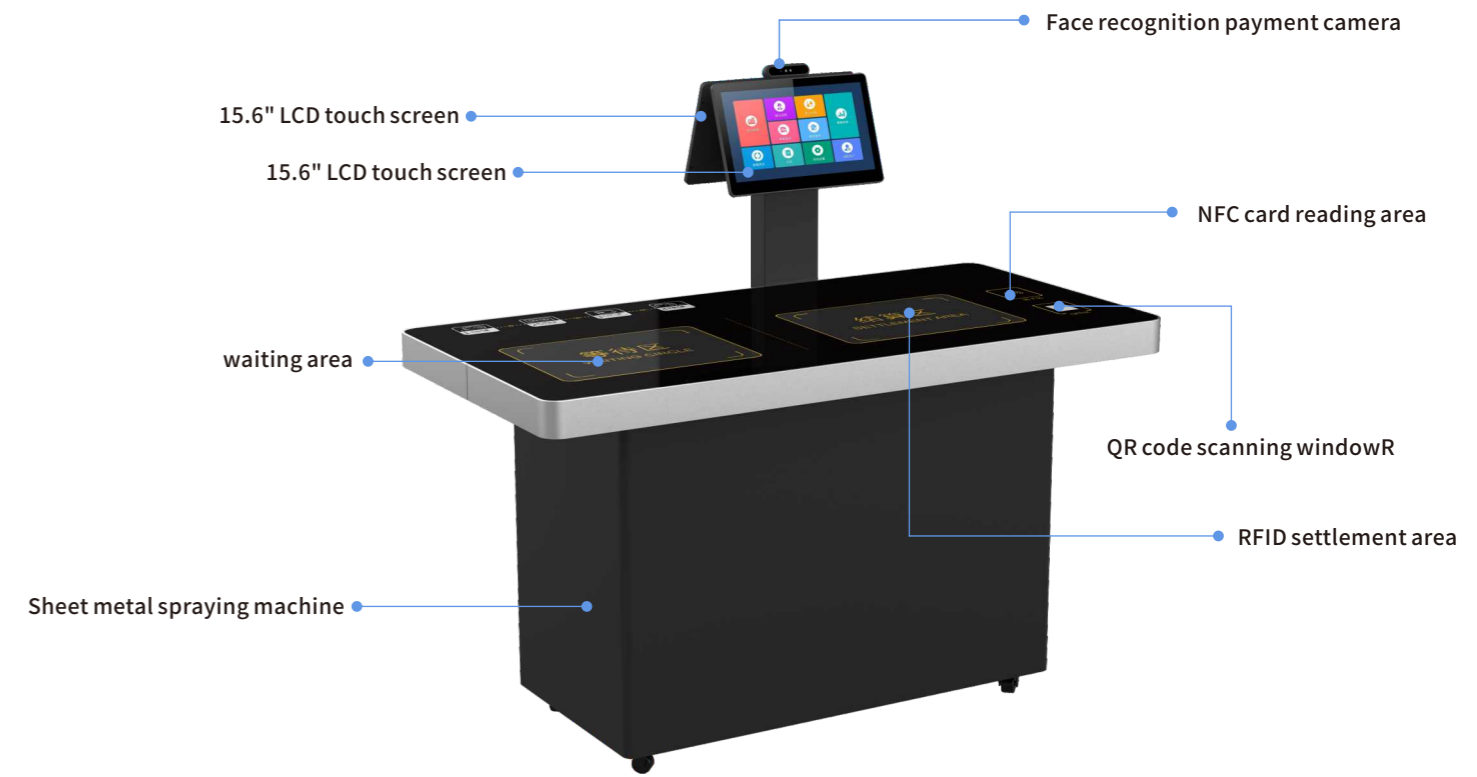

Product Parameters

Items	Product parameters
CPU	Rk3399 A72*2+ A53*4 CPU frequency 1.8GHz & Mail T860
Operation system	Android 7.1
Momery	4G DDR+16G EMMC
Power adapter	AC100-240V
Display screen	15.6" + 15.6" IPS, Resolutions:1920*1080+1920*1080
touch screen	G+G Multi-point capacitive touch
Scan code window	High-speed recognition, supports 1D/2D scanning of paper and screen
N F C	Support IC card swiping
Face recognition payment camera	200W dual-purpose wide dynamic camera/3D structured light camera optional
Speaker	3W*1
Standard network	RJ45、WIFI、Bluetooth
4G network	4G full network access (optional configuration)
Mechanical material	High-strength sheet metal stamping and spraying process
Device size	1400*700*1248mm
External I/O	USB Type A *2
	RJ45 LAN*1
	RS232*1
	Micro-USB*1

Visual recognition smart dining table Model:P913

Product features

- ★ Rk3399 high-performance six-core processor;
- ★ Based on the deeply optimized and improved operating system of Android, it supports the installation of apps based on Android system;
- ★ 13.3H+13.3H high-definition full-view display, supporting G+G multi-point capacitive touch;
- ★ 5 million pixel dish recognition camera, automatic recognition, and quick calculation of the entire menu price;
- ★ Supports 1D/2D scan code payment with wide viewing angle and fast recognition;
- ★ Built-in NFC card reading module supports card payment;
- ★ Optional face recognition payment camera can be used for multi-angle recognition;
- ★ The cabinet body is made of high-strength sheet metal stamping and spray-painting technology, and the structure is solid and reliable, beautiful and easy to clean;
- ★ It can provide appearance, configuration, and function customization, has strong scalability, and supports OEM/ODM.

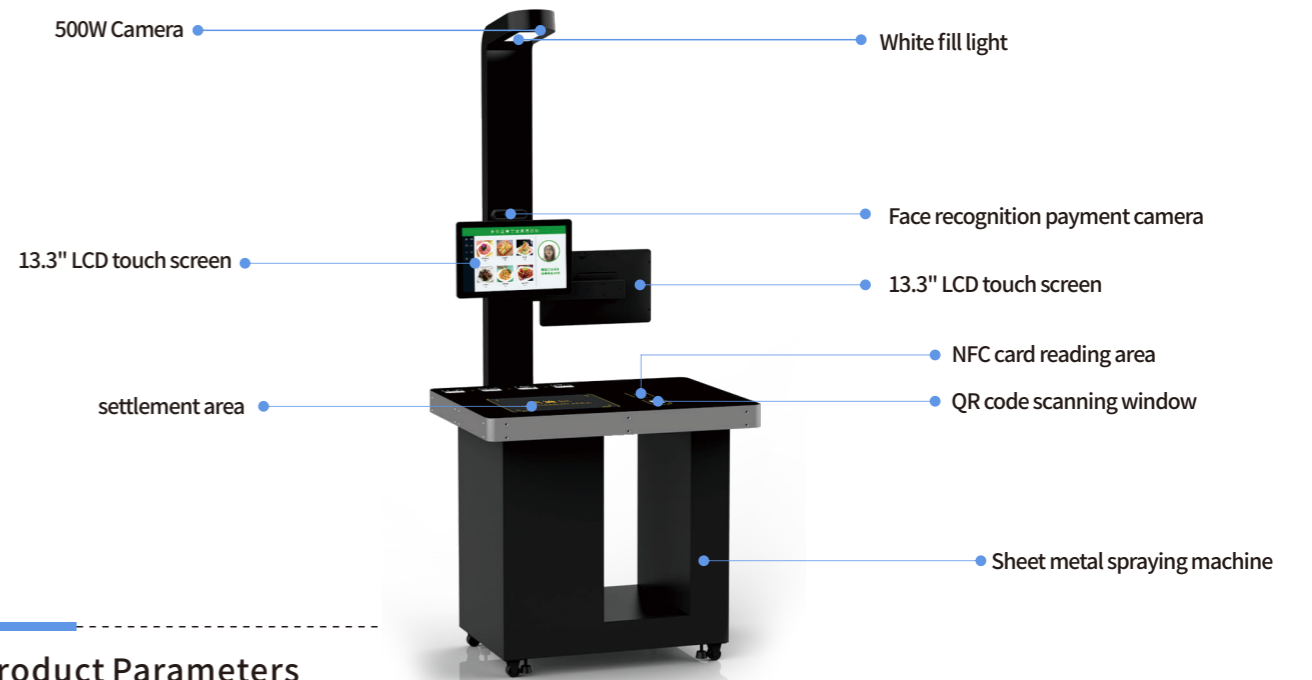

Product Parameters

Items	Product parameters
CPU	Rk3399 A72*2+ A53*4 CPU frequency 1.8GHz & Mail T860
Operation system	Android 7.1
Momery	4G DDR+16G EMMC
Power adapter	AC100-240V
Display screen	13.3" + 13.3" IPS,Resolutions:1920*1080+1920*1080
touch screen	G+G Multi-point capacitive touch
Dishes recognition camera	500W HD camera
Scan code window	High-speed recognition, supports 1D/2D scanning of paper and screen
N F C	Support IC card swiping
Face recognition payment camera	200W dual-purpose wide dynamic camera/3D structured light camera optional
Speaker	3W*1
Standard network	RJ45 , WIFI, Bluetooth
4G network	4G full network access (optional configuration)
Mechanical material	High-strength sheet metal stamping and spraying process
Device size	870*668*2004mm
External I/O	USBA *2
	RJ45 LAN*1
	AC Power port*1
	RS232
	Micro-USB Debug port *1



School Canteen



Company Cafe



Factory



Hospital



Restuarant

Bozz Technology (Shenzhen) Co., Ltd.

Smart R&D, smart manufacturing, smart IoT connects to the future

Bozz Technology (Shenzhen) Co., Ltd

Factory address: No.16, Jiayi Industrial Park, Zhangqi Road, Guixiang Community, Guanlan Street, Longhua District, Shenzhen
Tel.: 0755-29307923
Mobile: 13823152485
Fax: 0755-29524432
Website: www.bozztek.com
Email: sales@bozzteck.com

Changsha Subsidiary
Address: Floor 29, Building 3, Yulong Tianxia Jiayuan Complex/Phase 2, No. 799 Youmatang Road, Guanshaling Street, Yuelu District, Changsha City

Hong Kong Subsidiary
Address: Room D, Unit 607,6/F.,Metro Loft, 38 Kwai Hei St., Kwai Chung, N.T.,Hong Kong NT

Beijing Liaison Office
Address: Xiangrui Garden, No. 100 North Bailusi Street, Chaoyang District, Beijing

Shandong Subsidiary
Address: Jia-4, 155 Wenchang Road, Licang District, Qingdao, P.R. China



官方公众号



公司官网

