



Smart Security Series

Visitor Identification Device
Access Control & Attendance Device
Security Monitoring



- Face Recogniton
- ID Card Recognition
- QR Code Recognition
- Medical Card Recognition
- NFC Recognition
- Fingerprint identification
- Document Scanning
- AI Monitoring
- Support Customization
- SDK

Single Screen Facial&ID Card Recognition System Model:F1562/F1852

Product features

- * Android deep optimization and improved operating system, support the installation of Android system based on the APP;
- * Wide-dynamic binocular camera for live monitoring;
- * Efficient infrared fill light;
- * Optional NFC card reader, ID card reader, social security card reader;
- * Support public network and LAN deployment mode, optional 4G communication module;
- * Optional 15.6" or 18.5" HD screen, optional touch module, support single screen/dual screen.



Product Parameters

Items	Product parameters
CPU	RK 3288 A17*4 main frequency 1.8GHz & Mali T764
Operation system	Android 7.1 Bozz OS
Momery	2G DDR+32G EMMC optional: 16G/64G EMMC
Power adapter	12V/3A
Display screen	18.5"/15.6" optional, resolution: 1366*768
touch screen	G+G Multi-point capacitive touch
Camera	200W dual-purpose wide dynamic/3D structured light optional
card reader	Support IC card swiping (optional)
Scan code window	High-speed recognition, supports 1D/2D scanning of paper and screen
High-end shooting instrument	ID scanning high-photography (optional)
Speaker	3W*2
Standard network	RJ45, WIFI, Bluetooth
4G network	4G full network access (optional)
External I/O	USB Type-A *4
	RJ45 LAN port*1 (with indicator light)
	Micro-USB Debug port *1
	DC Power port*1
	3.5mm Headphone port *1
	SD card slot *1
	Mini USB*1

Facial&ID Card Recognition System Model:P18

Product features

- ★ Android deep optimization and improved operating system, support the installation of Android system based on the APP;
- ★ Dual-screen synchronous display, 10.1"/14"/15.61 multi-size combination to meet various needs and various application scenarios;
- ★ Multi-size combinations to meet various needs and application scenarios;
- ★ Face recognition, single/dual camera for liveness detection, optional, and clear backlighting ;
- ★ Supports ID card/medical insurance card/NFC card reading, optional fingerprint and A5 format high-definition camera.

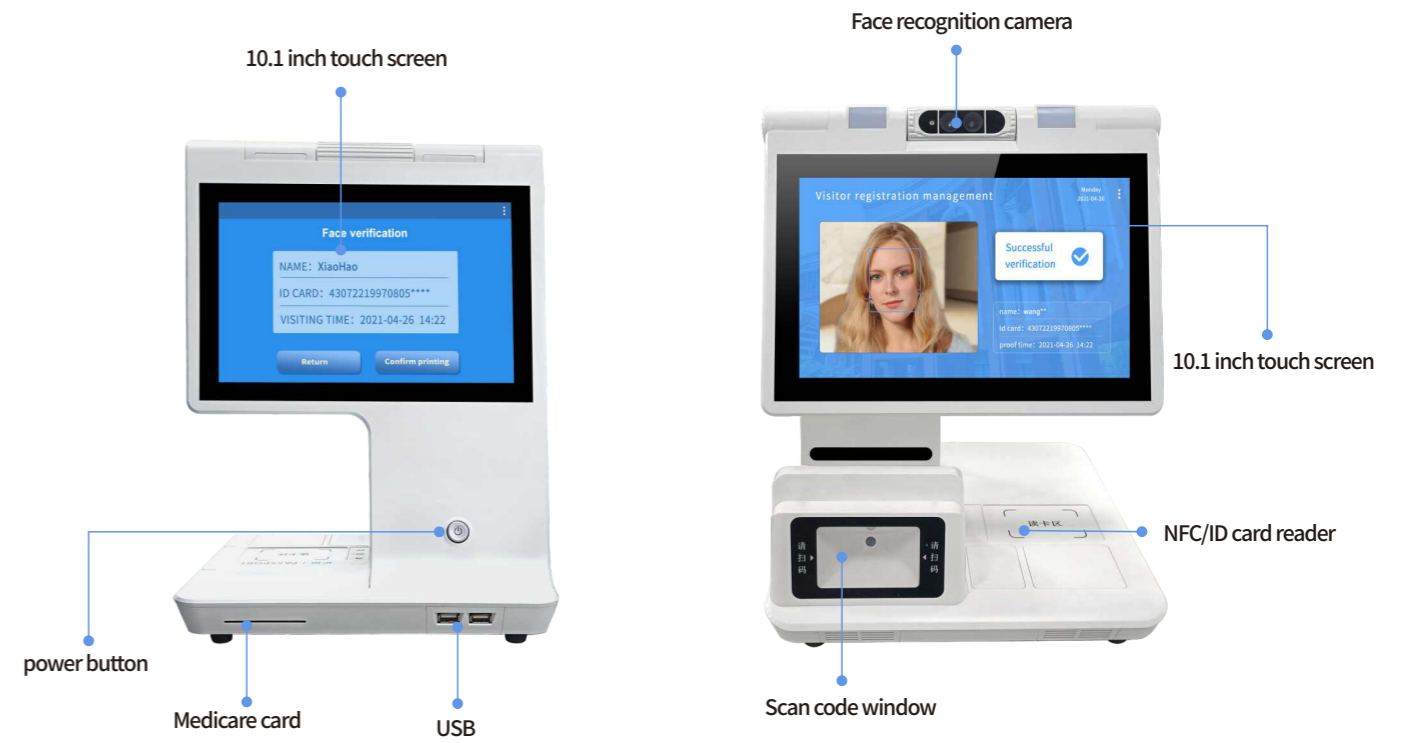

Product Parameters

Items	Product parameters
CPU	RK 3288 A17*4 main frequency 1.8GHz & Mali T764
Operation system	Android 7.1 Bozz OS
Momery	2G DDR+32G EMMC optional: 16G/64G EMMC
Power adapter	12V/3A
Display screen	10.1" (1280*800) 15.6" (1920*1080) optional
touch screen	G+G Multi-point capacitive touch
Camera	200W dual-purpose wide dynamic/3D structured light optional
card reader	Support IC card swiping (optional)
Scan code window	High-speed recognition, supports 1D/2D scanning of paper and screen
High-end shooting instrument	ID scanning high-photography (optional)
Fingerprint module	Capacitive fingerprint recognition (optional)
Speaker	3W*1
Standard network	RJ45, WIFI, Bluetooth
4G network	4G full network access (optional)
External I/O	USB Type-A *4
	Rj45 LAN*1
	Micro-USB Debug port *1
	DC Power port *1
	3.5mm Headphone port *1
	Supports Micro TF card slot*1, maximum 64G
	Supports optional HDMI*1

Facial&ID Card Recognition System Model:P12/P12 PLUS

Product features

- * Android deep optimization and improved operating system, support the installation of Android system based on the APP;
- * Dual-screen synchronous display, 12.1"/14"/15.61 multi-size combination to meet various needs and various application scenarios;
- * Supports scanning the mobile phone to reserve the visitor code, making visitors more efficient and faster;
- * The face recognition camera (single/dual camera optional) supports human body sensing and eliminates photo recognition;
- * Built-in 58mm printer, fast printing of visitor receipts, built-in cutter, no paper jam;
- * Optional human body temperature measurement module.

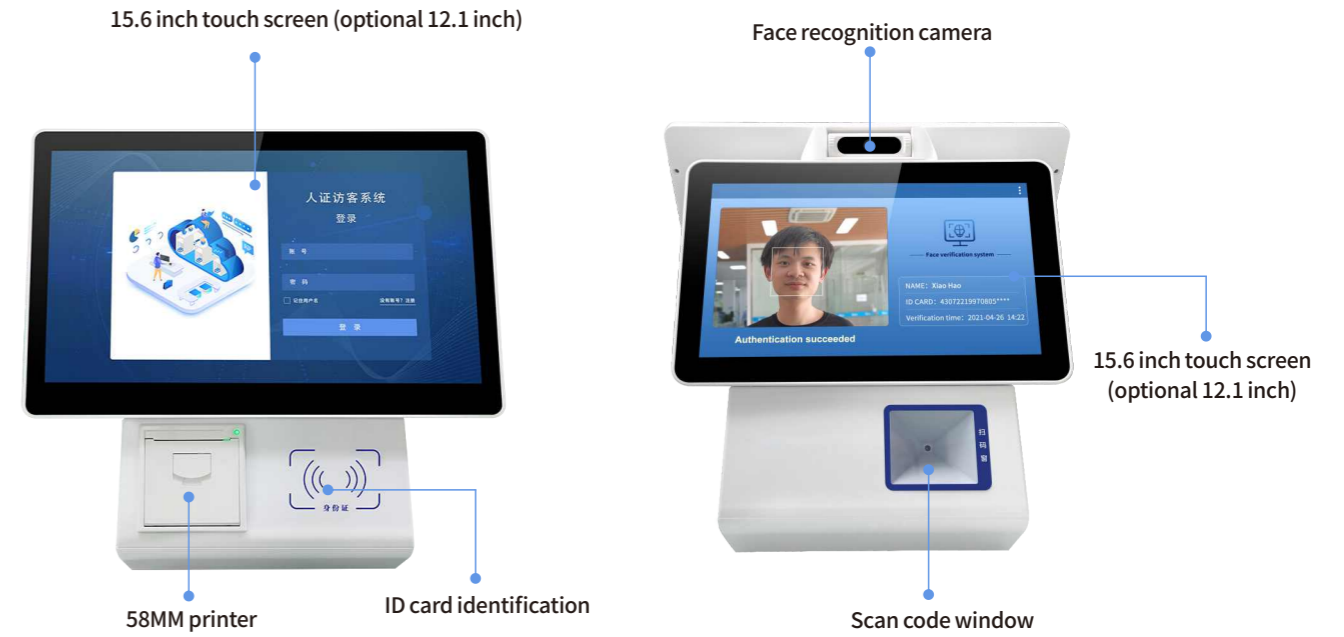

Product Parameters

Items	Product parameters
CPU	RK 3288 A17*4 main frequency 1.8GHz & Mali T764
Operation system	Android 7.1 Bozz OS
Momery	2G DDR+32G EMMC optional:16G/64G EMMC
Power adapter	12V/3A
Display screen	12.1" (1600*900) 14"/15.6" (1920*1080) optional
touch screen	G+G Multi-point capacitive touch
Camera	200W dual-purpose wide dynamic/3D structured light optional
Scan code window	High-speed recognition, supports 1D/2D scanning of paper and screen
card reader	Support IC card swiping (optional)
printer	58 mm Thermal printer, with automatic cutter
Measure temperature	Human body temperature measurement module (optional)
Speaker	3W*1
Standard network	RJ45 , WIFI, Bluetooth
4G network	4G full network access (optional configuration)
External I/O	USB Type-A *4
	RJ45 LAN*1
	Micro-USB Debug port*1
	DC Power port *1
	3.5mm Headphone port *1
	Supports Micro TF card slot*1, maximum 64G
	Supports optional HDMI*1

Double Screen Facial&ID Card Recognition System Model:P22HC

Product features

- ★ Android deep optimization and improved operating system, support the installation of Android system based on the APP;
- ★ 12.1"/13.3"/15.6" supports three screen size combinations;
- ★ Wide dynamic range dual-camera, supporting in-vivo monitoring;
- ★ Optional NFC card reader, ID card reader, social security card reader;
- ★ Optional 5 million pixel high-definition camera, supporting up to A4 format high-definition shooting;
- ★ Supports public network and local area network deployment methods, optional 4G communication module.

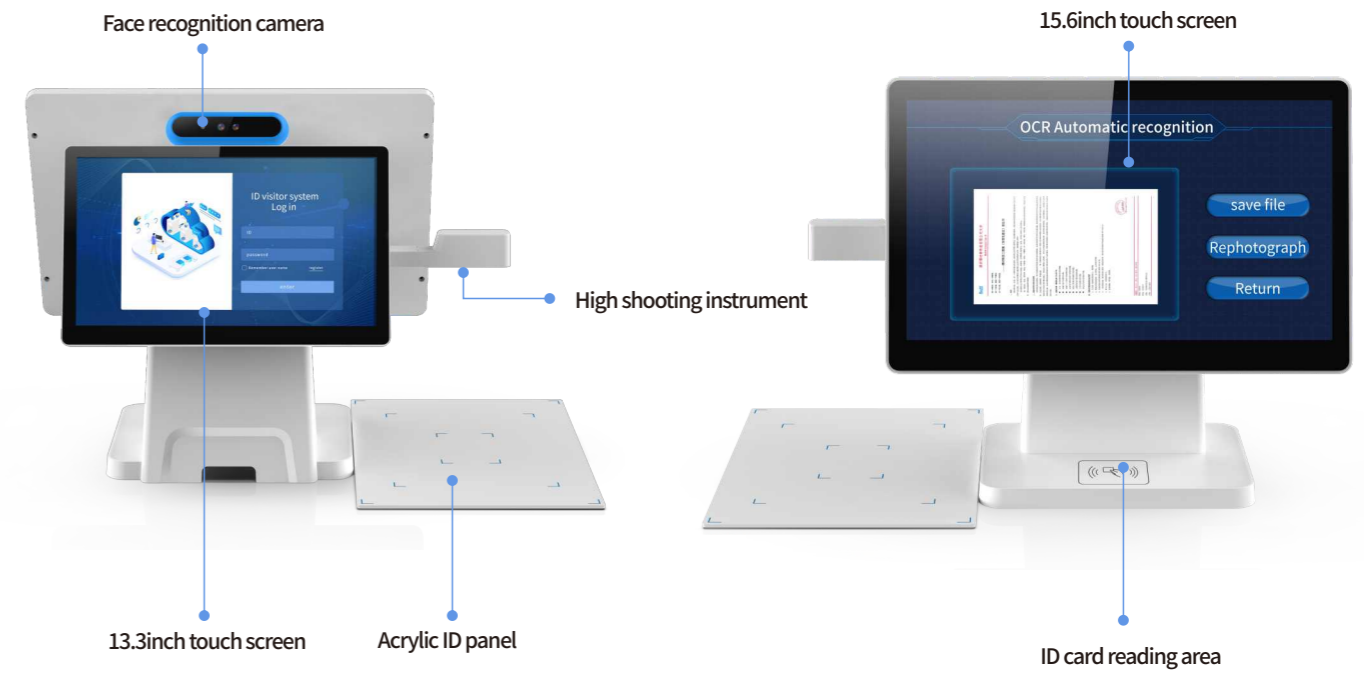

Product Parameters

Items	Product parameters
CPU	RK 3288 A17*4 main frequency 1.8GHz & Mali T764
Operation system	Android 7.1 Bozz OS
Momery	2G DDR+32G EMMC optional:16G/64G EMMC
Power adapter	12V/3A
Display screen	12.1" + 15.6" IPS,resolutions:1600*900+1920*1080
touch screen	G+G capacitive multi-touch
Camera	200W dual-purpose wide dynamic/3D structured light optional
card reader	NFC card reading module
High-end shooting instrument	5 million pixels, supports up to A4 format high-definition shooting (optional)
Speaker	3W*1
Standard network	RJ45, WIFI, Bluetooth
External I/O	USBA *2
	RJ45 LAN*1
	DC Power port*1
	SIM card holder (standard when 4G module is selected)
	Support Micro TF card slot

Face recognition temperature measurement and access control equipment Model:F0802

Product features

- ★ CNC precision machining shell technology, IP65 waterproof design, blue sexy waistline, high-gloss polished edges;
- ★ Rich external ports, RS485, RJ4, relay, USB, DC-IN, RJ45 are all available;
- ★ 8-hHD screen, you can also split-screen to play advertisements when swiping your face, multi-point capacitive touch, easy to operate, quick response;
- ★ Equipped with dual-purpose wide dynamic cameras for live body detection, body temperature module is optional;
- ★ It has obtained CE certification and has entered overseas markets in large quantities;
- ★ Can be expanded to include 3D structured light cameras, ID boxes, fingerprint modules, etc.

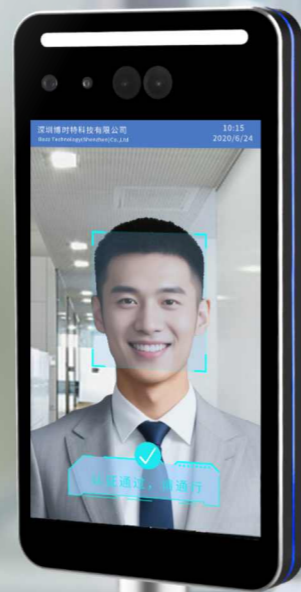

Product Parameters

Items	Product parameters
CPU	RK 3288 A17*4 main frequency 1.8GHz & Mali T764
Operation system	Android 7.1 Bozz OS
Momery	2G DDR+32G EMMC optional:16G/64G EMMC
Power adapter	DC 12V/2A
Display screen	8" Full-view , Resolution:800*1280
touch screen	G+G capacitive multi-touch (optional)
Camera	200W binocular wide dynamic
Temperature measurement module	Infrared temperature measurement module (optional)
Card reader	NFC card reader module/ID card module (optional)
Speaker	2W*1
Standard	RJ45, WIFI, Bluetooth (optional 4G full Netcom)
External I/O	USB Type-A *1
	RJ45 LAN*1
	DC power port *
	Relay interface*1
	RS485 port *1
	Root interface*1

Face recognition temperature measurement forbidden equipment

Model: S800/S800W/S800D

Product features

- ★ 8 inch IPS screen, resolution 800*1280;
- ★ Dual-core ARM Cortex-A53 processor, running Linux system, stable system;
- ★ Binocular face recognition, support infrared liveness detection;
- ★ Long-distance non-contact temperature measurement, accurate temperature measurement, 1S rapid temperature measurement;
- ★ Support face tracking and exposure of personnel movement in strong backlight environment;
- ★ Support NFC swipe card recognition.

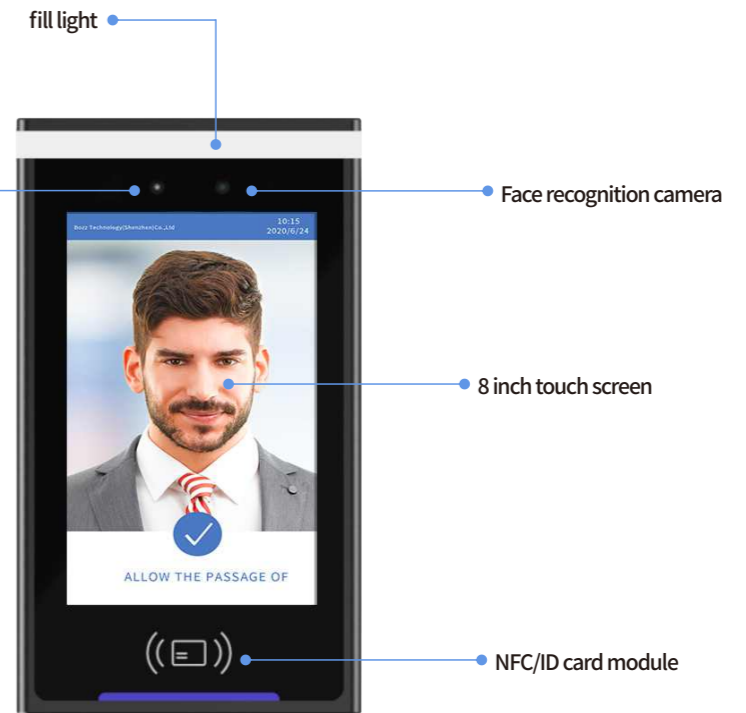

Product Parameters

Items	Product parameters
CPU	Cortex-A53@1.0 GHz+1.5T Deep Learning Algorithm Accelerator (NPU)
Operation system	Linux System
Momery	512MB/1GBDDR +8GEMMC
Power adapter	DC 12V/2A
Display screen	8" Full view, resolutions:800*1280
touch screen	G+G capacitive multi-touch (optional)
Camera	200W binocular wide dynamic
Temperature measurement module	Infrared temperature measurement module (optional)
Card reader	NFC card reader module/ID card module (optional)
Speaker	2W*1
Standard	RJ45, WIFI, Bluetooth (optional 4G full Netcom)
External I/O	USB Type-A *1
	RJ45 LAN*1
	DC power port *
	Relay interface *1
	serial port *1
	Root interface *1
	4G antenna (optional)

Face recognition and access attendance equipment Model:F830

Product features

- ★ One piece design, the overall appearance is simple and large, and the model is smooth;
- ★ Rich external interfaces, RS485, Wiegand, Relay, USB, DC-IN, RJ45 are all available;
- ★ Compatible with 7-inch and 8-inch screen, with optional CPU RK3288 or RK PX30 ;
- ★ Equipped with 2.0 binocular wide dynamic camera camera for life detection, body temperature detection module is optional;
- ★ High intensity fill light, clear recognition even in backlighting situation;
- ★ Aviation grade die cast aluminum alloy (or plastic mold), surface painted, protection grade IP66.

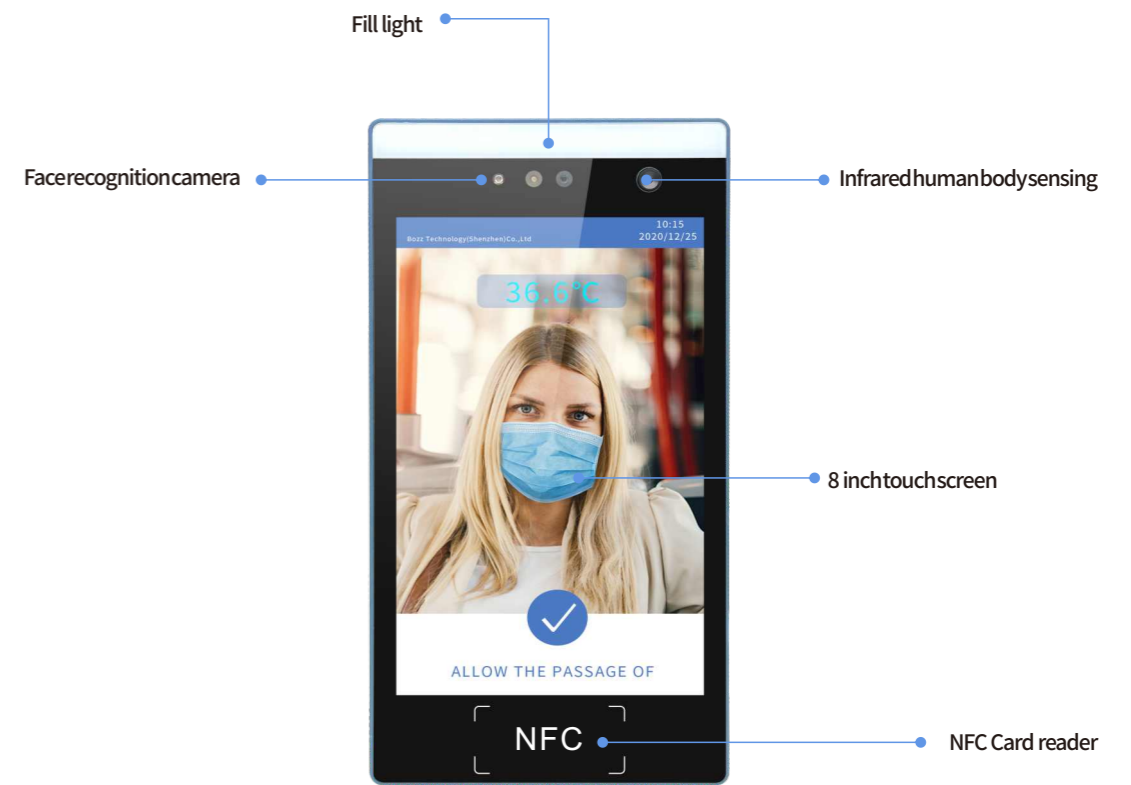

Product Parameters

Items	Product parameters
CPU	Rk PX30
OS	Android 8.1 Bozz OS
Memory	1G DDR+8G EMMC Optional:2G DDR+16G/32G/64G EMMC
Power adapter	12V/2A
Display screen	8" IPS, resolution: 800*1280
Touch Screen	G+G capacitive multi-points touch screen (optional)
Camera	2.0M binocular wide dynamic camera
Card reader	NFC card reader module (optional)
Speaker	3W*1
Standard network	RJ45,WIFI 2.4GHZ, Bluetooth
4G communication	4G module (optional)
External I/O	USB Type-A *1
	RJ45 LAN*1
	DC Power port*1
	Relay interface*1
	RS485 interface*1
	Root interface *1

Face recognition door access attendance machine equipment

Model: F501 /F502

Product features

- ★ Small and exquisite, full-featured, extremely cost-effective;
- ★ It is easy to install with the 86 box, and can be built-in or plug-in;
- ★ 5" TFT LCD screen, resolution 854*480;
- ★ 200W high-definition camera, with three-color fill light, accurate recognition in day and night;
- ★ Built-in card reader, optional ID card recognition and IC card recognition;
- ★ Supports RS-485 serial port, built-in relay, multiple I/O inputs and outputs, magnetic output;
- ★ Supports public network and local area network deployment methods, optional 4G communication module.



Product Parameters

Items	Product parameters
CPU	Rk3288 A17*4 Main frequency 1.8GHz & Mali T764
OS	Android 7.1 Bozz OS
Memory	2G DDR+8G EMMC Optional:4G DDR+16G/32G/64G EMMC
Power adapter	12V/3A
Display screen	5" IPS, resolution:480*854
touch	G+G capacitive multi-touch (optional)
Camera	200W dual-purpose wide dynamic range
card reader	NFC card reader module/ID card module (optional)
Scan code window	High-speed recognition, supports 1D/2D scanning of paper and screen (optional)
speaker	2W*1
Standard network	RJ45, WIFI, Bluetooth (4G full network optional)
External I/O	Micro-USB Debug port *1 *1
	RJ45 LAN*1
	DC Power por*1
	Relay interface*1
	RS485 interface*1
	ALM Door lock button switch interface*1

Face recognition access control equipment with temperature measurement

Model: F702

Product features

- ★ Based on the deeply optimized and improved operating system of Android, it supports the installation of apps based on the Android system;
- ★ 7-inch capacitive touch screen, supports multi-points sensitive touch;
- ★ 2.0M binocular wide dynamic camera, supports living object detection;
- ★ Equipped with the exquisite and cool fill light, which can make accurate face recognition even at night;
- ★ NFC card reader, ID card reader, and X86 installation box are optional;
- ★ Supports RS-485 serial port, build-in Relay, multiple I/O interfaces, and electromagnetic door lock output;
- ★ Supports public network and LAN deployment methods, 4G module optional.

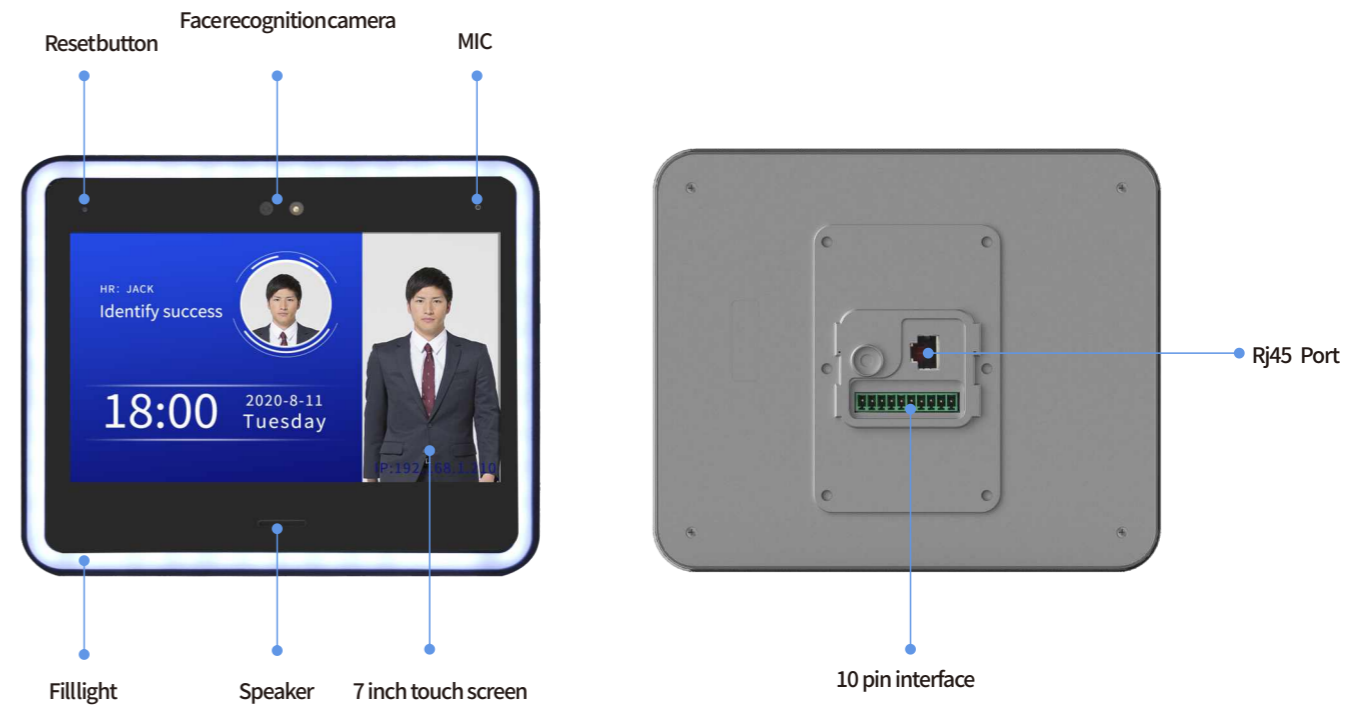

Product Parameters

Items	Product parameters
CPU	Rk PX30
OS	Android 7.1 Bozz OS
Memory	1G DDR+8G EMMC Optional:4G DDR+16G/32G/64G EMMC
Power adapter	12V/3A
Display screen	7" IPS , resolution:800*480
Touch screen	G+G capacitive multi-points touch screen (optional)
Camera	2.0M binocular wide dynamic camera
Temperature measurement module	Infrared temperature measurement module (optional)
Speaker	2W*1
Standard network	RJ45,WIFI 2.4Ghz,Bluetooth
4G communication	4GModule(optional)
External I/O	Micro-USB Debug port *1
	RJ45 LAN *1
	DC Power port *1
	Relay interface*1
	RS485 interface*1
	ALM Door lock button switch interface*1

Conference room face recognition access control equipment

Model:F1333

Product features

- ★ 13.3inch 1080P high-definition conference door is disabled, and the IPS screen is fully visible;
- ★ 2 million cameras, speakers, microphones, voice and video calls without delay;
- ★ multi-point capacitive touch, convenient and quick to operate and edit meeting content;
- ★ Supports high-end customization and can expand 4G modules, HDMI, etc;
- ★ Suitable for conference rooms of enterprises and institutions, large conference rooms, exhibition centers, etc.



Product Parameters

Items	Product parameters
CPU	Rk3399 A72*2+ A53*4 Main frequency 1.8GHz & Mail T864
OS	Android 7.1 Bozz OS
Memory	4G DDR+16G EMMC Optional:32G/64G EMMC
Power adapter	12V/2A
Display screen	13.3" full viewing angle, resolution: 1920*1080
touch	G+G capacitive multi-touch (optional)
Camera	200W dual-purpose wide dynamic range
Temperature measurement module	Infrared temperature measurement module (optional)
Speaker	2W*1
standard network	RJ45, WIFI, Bluetooth (4G full network optional)
4G communication	4G full network communication (optional)
External I/O	USB Type-A *1
	RJ45 LAN*1
	Micro-USB Debug port *1
	DC Power port*1
	Supports Micro TF card slot*1, maximum 64G
	Dedicated function extension*1

Smart campus electronic class signage equipment

Model:F185

Product features

- ★ 18.5" high definition full view electronic class sign;
- ★ Can have a built-in camera to support living body detection;
- ★ Built-in NFC module, which can read IC cards, common campus cards, smart cards, etc;
- ★ Multi-point capacitive touch makes course management and information editing easy and fast;
- ★ Supports high-end customization, can expand temperature measurement functions, 4G modules, HDMI, etc;
- ★ Suitable for class signs and entry and exit scenarios in enterprises, schools, training institutions, hospitals, administrative units, etc.



Product Parameters

Items	Product parameters
CPU	Rk3399 A72*2+A53*4 Main frequency 1.8GHz & Mail T864
OS	Android 7.1 Bozz OS
Memory	4G DDR+16G EMMC Optional:32G/64G EMMC
Power adapter	12V/3A
Display screen	18.5" Full viewing angle, resolution:1920*1080
touch	G+G capacitive multi-touch
Camera	200W HD/dual wide dynamic range (optional)
card reader	NFC card reading module (optional)
Temperature measurement module	Infrared temperature measurement module (optional)
Speaker	2W*2
standard network	RJ45, WIFI, Bluetooth (4G full network optional)
External I/O	USB Type-A *2
	RJ45 LAN*1
	DC power port *1
	Micro-USB Debug port *1
	Supports Micro TF card slot*1, maximum 64G
	3.5mm headphone port*1

Smart campus electronic class signage equipment

Model: F2153

Product features

- ★ 21.5" high definition full view electronic class sign;
- ★ Can have built-in camera to support living body detection;
- ★ Built-in NFC module, can read IC cards, common campus cards, smart cards, etc;
- ★ Multi-point capacitive touch makes course management and information editing easy and fast;
- ★ Supports high-end customization, can expand temperature measurement functions, 4G modules, HDMI, etc.



NFC card reading area

Infrared temperature measurement

Face recognition camera

21.5 inch touch screen

Product Parameters

Items	Product parameters
CPU	Rk3288 A17*4 main frequency 1.8GHz & Mali T764
OS	Android 7.1 Bozz OS
Memory	4G DDR+16G EMMC Optional:32G/64G EMMC
Power adapter	12V/3A
Display screen	21.5" full viewing angle, resolution: 1920*1080
touch	G+G capacitive multi-touch
Camera	200W HD/dual wide dynamic range (optional)
card reader	NFC card reading module (optional)
Temperature measurement module	Infrared temperature measurement module (optional)
Speaker	2W*2
standard network	RJ45, WIFI, Bluetooth (4G full network optional)
External I/O	USB Type-A *2
	RJ45 LAN*1
	Mini-USB Debug port*1
	DC Power port*1
	Supports Micro TF card slot*1(maximum 64G)
	3.5mm headphone port*1

Security Camera Series



BH201 Dome Camera

Features of BH201:

- ★ Ultra-strong SoC vision processor, NPU RV1109 with 1.2Tops computing power
- ★ 2-megapixel starlight-level sensor
- ★ Front-end snapshot and front-end analysis
- ★ Codec SMART H.265/H.264+
- ★ 1080P @ 60 FPS



Bc201 Bullet Camera

Features of BC201:

- ★ Ultra-strong SoC vision processor, NPU RV1109 with 1.2Tops computing power
- ★ 2M/4M starlight-level sensor
- ★ Front-end snapshot and front-end analysis
- ★ Codec SMART H.265/H.264+
- ★ 1080P @ 60 FPS
- ★ Optional electric focus lens
- ★ Protection class IP66



BA401 PTZ Camera

Features of BA401:

- ★ Ultra-strong SoC vision processor, NPU RV1109 with 1.2Tops computing power
- ★ 4M/5M starlight - level sensor
- ★ Front - end snapshot and front - end analysis
- ★ Codec SMART H.265/H.264+
- ★ 1080P @ 60 FPS
- ★ Auto - focus
- ★ Two - axis adjustment: H: 360°, V: 0 - 75°
- ★ Protection class IP66

Bozz Technology (Shenzhen) Co., Ltd.

Smart R&D, smart manufacturing, smart IoT connects to the future

Bozz Technology (Shenzhen) Co., Ltd

Factory address: No.16, Jiayi Industrial Park, Zhangqi Road, Guixiang Community, Guanlan Street, Longhua District, Shenzhen
Tel.: 0755-29307923
Mobile: 13823152485
Fax: 0755-29524432
Website: www.bozztek.com
Email: sales@bozzteck.com

Changsha Subsidiary
Address: Floor 29, Building 3, Yulong Tianxia Jiayuan Complex/Phase 2, No. 799 Youmatang Road, Guanshaling Street, Yuelu District, Changsha City

Hong Kong Subsidiary
Room D, Unit 607,6/F.,Metro Loft, 38 Kwai Hei St., Kwai Chung, N.T.,Hong Kong NT

Beijing Liaison Office
Address: Xiangrui Garden, No. 100 North Bailusi Street, Chaoyang District, Beijing

Shandong Subsidiary
Address: Jia-4, 155 Wenchang Road, Licang District, Qingdao, P.R. China



官方公众号



公司官网

